



South Bay Foundry

WWW.SOUTHBAYFOUNDRY.COM

PHONE: (619) 956-2780 FAX: (619) 956-2788

SBF 1907

36" FRAME AND COVER
SAC. AREA SEWER DIST.
ID# A5660 / A5680

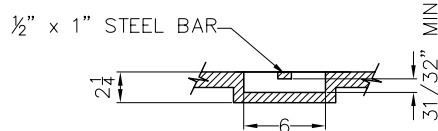
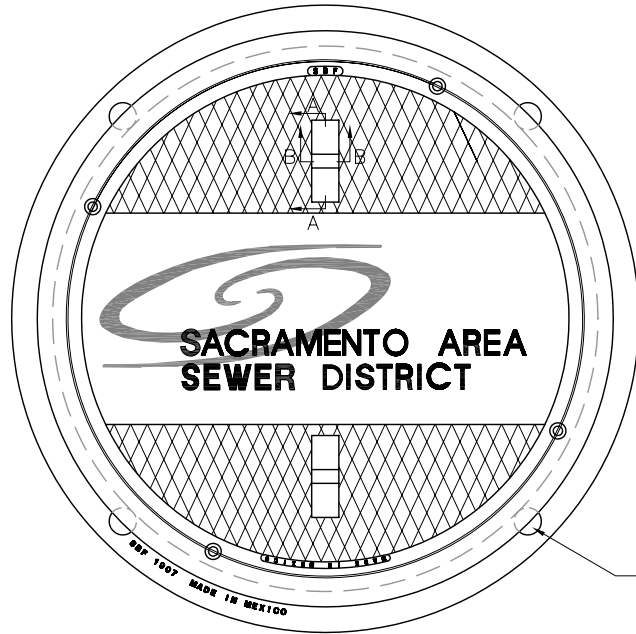

SECTION A-A

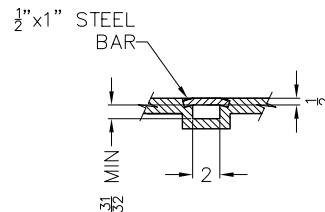

SECTION B-B

(4) 1" ϕ HOLES
 EQUALLY SPACED

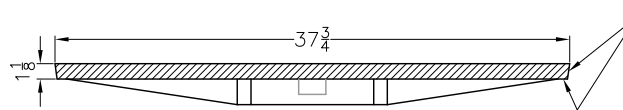

MACHINED FOR
 CLOSE, QUIET FIT

0.125 R GROOVE FOR 1/4" NEOPRENE O-RING GASKET AND SHALL BE GLUED INTO PLACE. GLUE SHALL MEET MIL-M-81288 (AMEND 1)

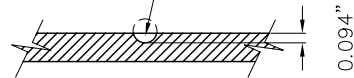

O-RING DETAIL

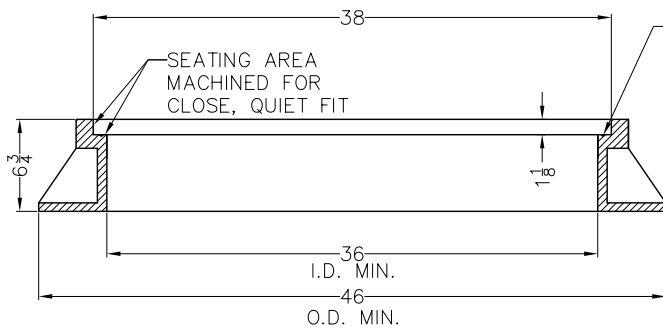

GROOVE FOR 1/4" NEOPRENE O-RING GASKET AND SHALL BE GLUED IN PLACE. GLUE SHALL MEET MIL-M-81288.

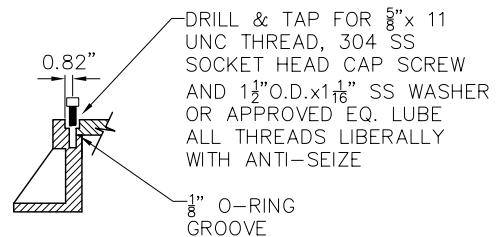

BOLT DETAIL

GENERAL INFORMATION

- *All materials used in manufacturing shall conform to ASTM 48. Class 35B.
- *Frame and cover bearing surfaces shall be machined to assure close, quiet fit.
- *Frame and cover exceeds H-20 wheel loading.

APPROVED

BY:

TITLE:

AGENCY:

DATE:

04-30-10